

**Proposed Project at Mouza-Uluberia, J.L. No-109,
R.S. Dag No-610, L.R. Dag No-750, L.R. Khatian
No-4123 & 4796, Ward No-26, under Uluberia
Municipality, P.S.-Uluberia, District-Howrah**

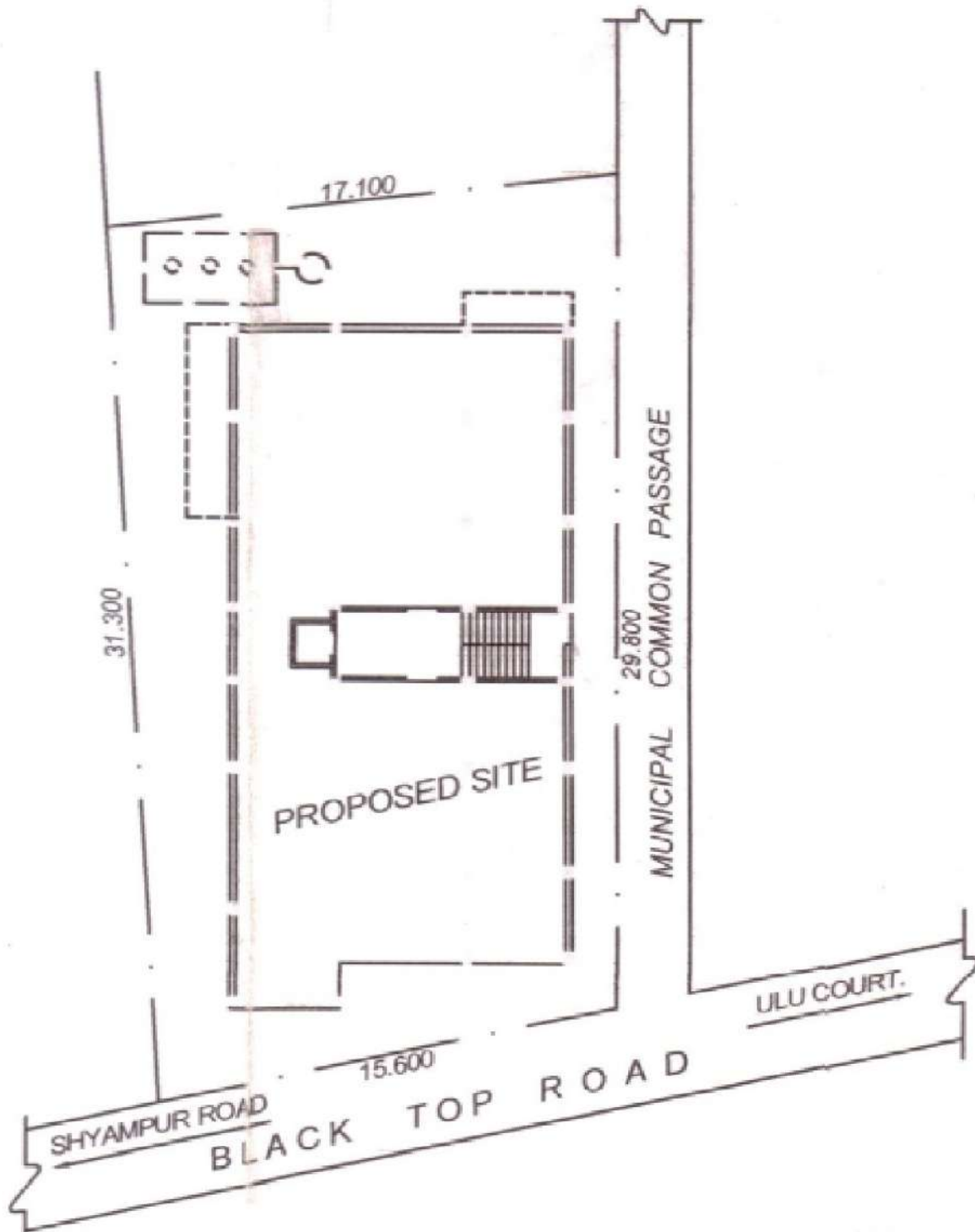

LATITUDE : 22.468445
LONGITUDE : 88.093212

ROYAL CONSTRUCTION
Surajit Banerjee
Partner

SIGNATURE OF OWNER